

SFD MULTI-GRIP 3.2/4.0/4.8

Mandrel: Steel Body: Steel. Dome Head.

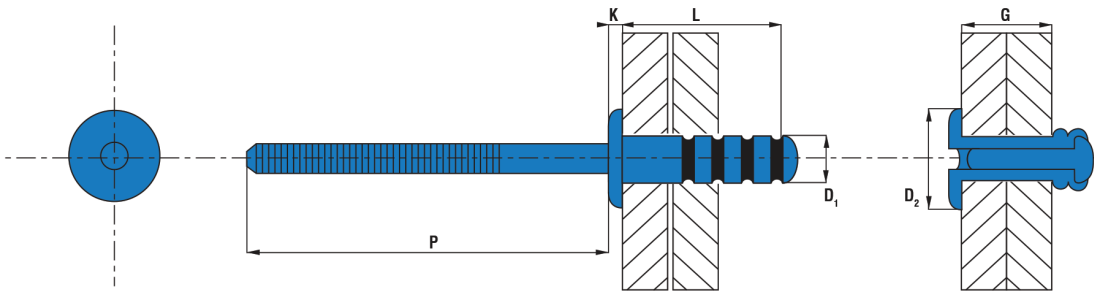

SFD3.2-4.8FICHE



PART NO/REF	D ₁	L	D ₂	K	Hole diameter	P	G
	Ø (mm)	(mm) +1.0 / -0.2	Ø (mm)	(mm)	Ø (mm)	min (mm)	min-max (mm)
SFD3209	3.2 +0.08 / -0.10	9.0	7.2 -0.25 / +0.25	1.0 -0.15 / +0.15	3.3	27	1.1-4.0
SFD3213		12.0					1.0-9.0
SFD4010	4.0 +0.08 / -0.15	10.8	8.1 -0.25 / +0.25	1.5 -0.15 / +0.15	4.1	27	1.4-4.8
SFD4012		12.5					2.9-7.0
SFD4810	4.8 +0.08 / -0.15	10.2	9.8 -0.25 / +0.45	1.8 -0.30 / +0.20	4.9	27	1.4-5.0
SFD4812		12.7					3.5-7.5
SFD4814		14.0					1.5-9.0
SFD4817		17.5					7.5-12.5

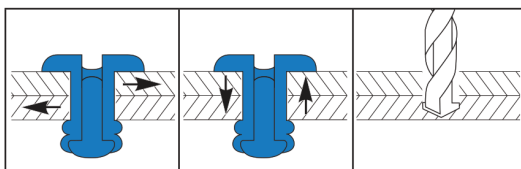

D ₁ (mm)	(N)	(N)	Ø (mm)
3.2	1 500	1 700	3.3
4.0	1 955	2 350	4.1
4.8	3 335	3 600	4.9